

SECTION AT - AA
RESIDENTIAL BUILDING
(BUNGLOW)
SCALE-1:100

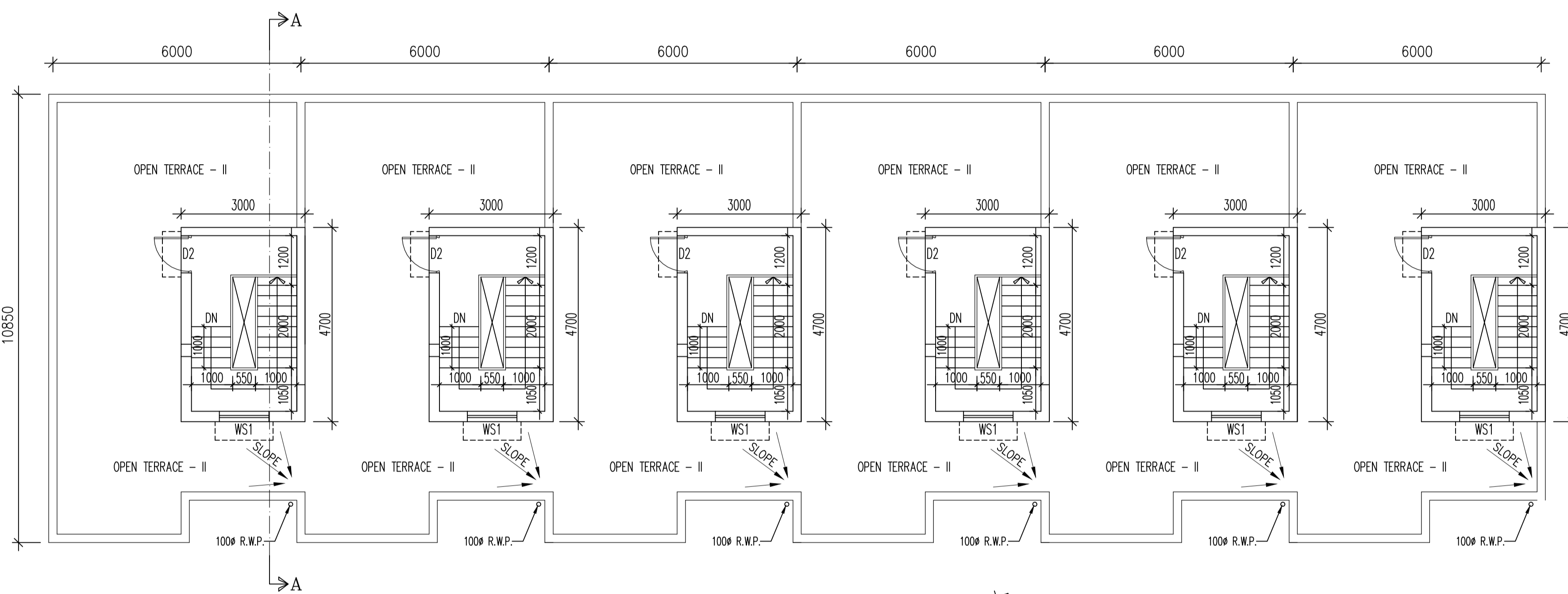

FRONT ELEVATION
RESIDENTIAL BUILDING
(BUNGLOW)
SCALE-1:100



RESIDENTIAL BUILDING (BUNGLOW)
ROOF PLAN
SCALE-1:100

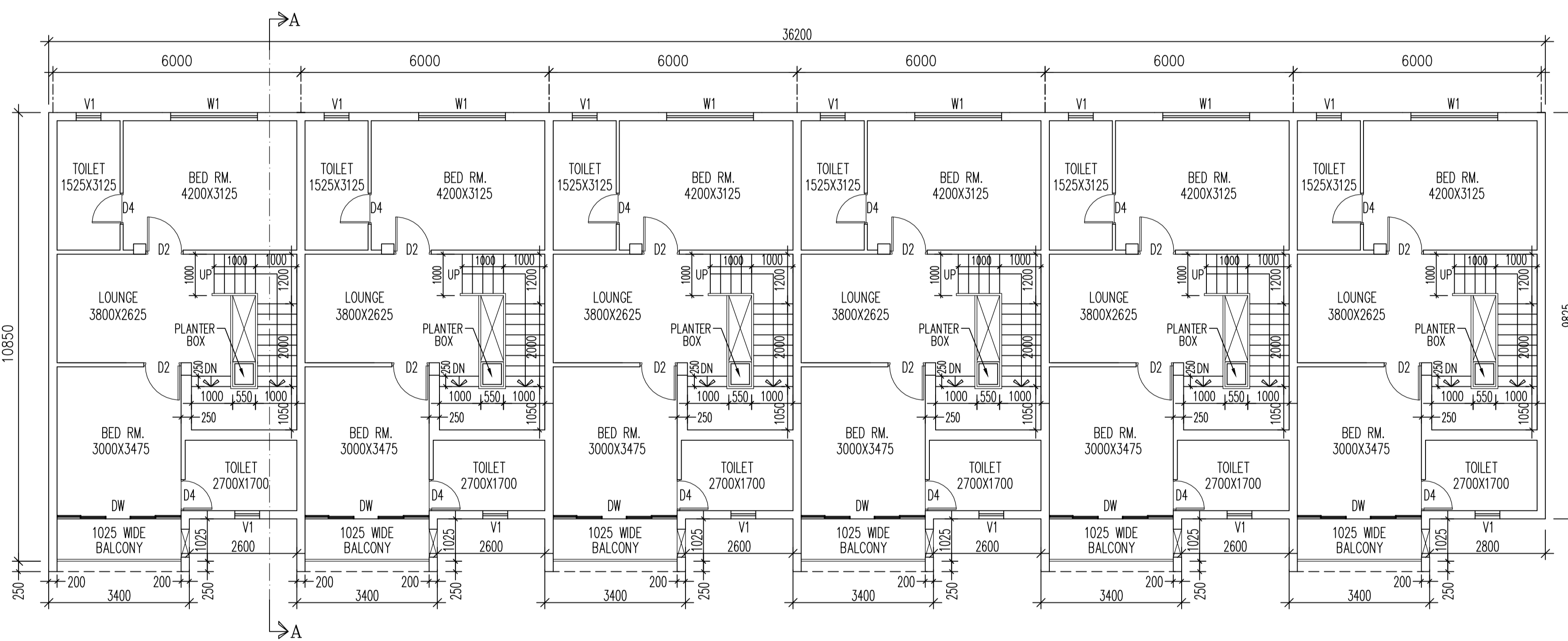

RESIDENTIAL BUILDING (BUNGLOW)
1ST FLOOR PLAN
SCALE-1:100

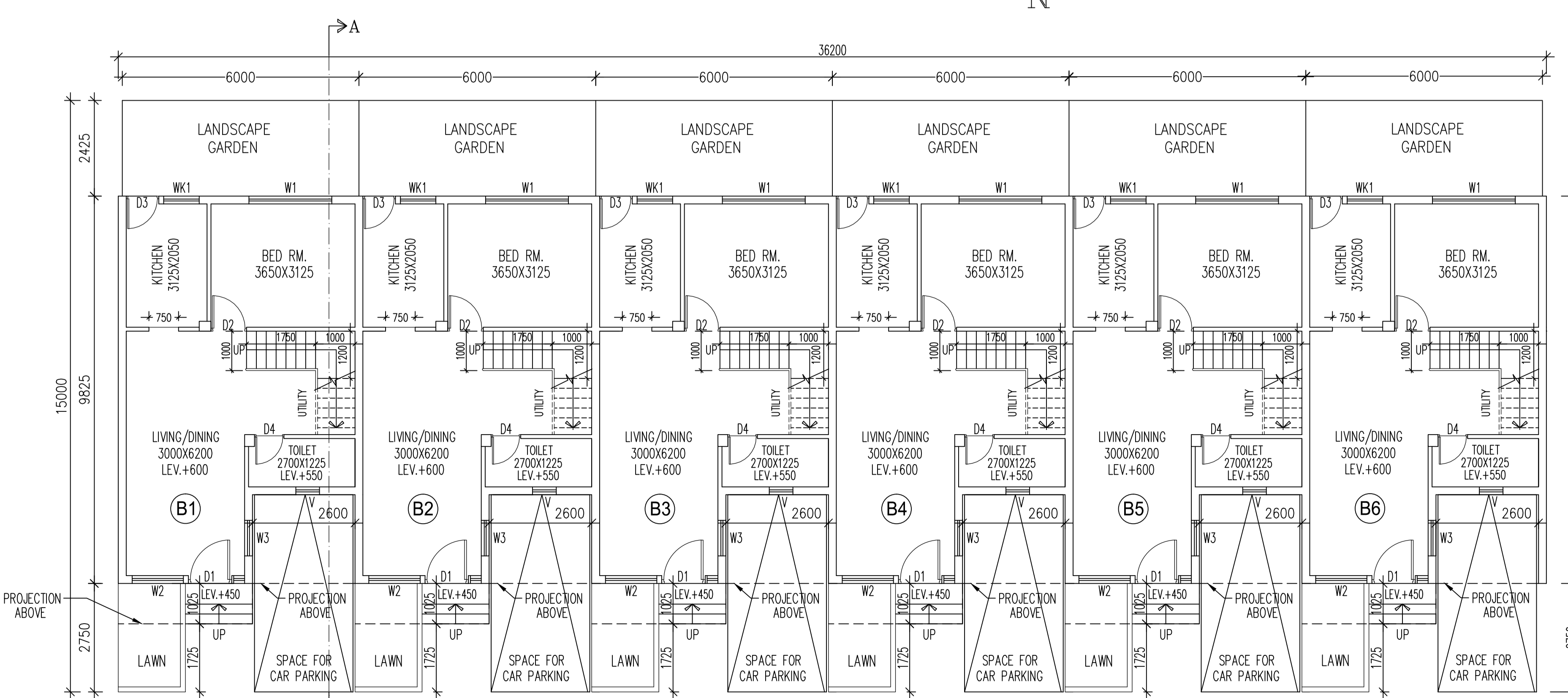

RESIDENTIAL BUILDING (BUNGLOW)
GROUND FLOOR PLAN
SCALE-1:100

DOORS & WINDOWS SCHEDULE							
TYPE	SILL	LINTEL	SIZE	TYPE	SILL	LINTEL	SIZE
D1	-	2250	1100X2250	W1	275	2250	2100X1975
D2	-	2250	900X2250	W2	275	2250	1300X1975
D3	-	2250	825X2250	W3	275	2250	900X1975
D4	-	2250	750X2250	WK	1050	2250	1200X1200
DW	-	2250	3000X2250	WK1	1050	2250	900X1200
GD	-	2250	1500X2250	WS	900	2250	1200X1350
GD1	-	2250	1350X2250	WS1	600 FROM ROOF LEVEL TO 2250 FROM ROOF LEVEL	2250	1200X1650
SLD	-	2250	1500X2250	V	AS PER SITE	2250	600X900
				V1	1350	2250	600X900

GENERAL NOTES

1. ALL DIMENSIONS ARE IN MM.
2. ALL EXTERNAL WALLS 200 THK. & INTERNAL WALLS 75 THK. UNLESS OTHERWISE MENTIONED.
3. ALL MASONRY WORKS ARE BOUNDED BY CEMENT MORTAR (1:6) & (1:4).
4. EXTERNAL PLASTER IS 25 THK. & INTERNAL PLASTER IS 12MM. THK. WITH 1:4 MORTAR.
5. ALL CONC. GRADE IS M200 (1:1.5:3).

1. I ENGAGED ARCHITECT AND E.S.E DURING CONSTRUCTION
2. I FOLLOWED THE INSTRUCTIONS OF ARCHITECT AND E.S.E DURING CONSTRUCTION OF THE BUILDING.
3. K.M.C AUTHORITY WILL NOT BE RESPONSIBLE FOR STRUCTURE STABILITY OF BUILDING AND ADJOINING STRUCTURE.
4. IF ANY SUBMITTED DOCUMENT IS FOUND TO BE FAKE THE K.M.C AUTHORITY MAY REVOKE THE SANCTION PLAN.
5. THE CONSTRUCTION OF WATER RESERVOIR AND SEPTIC TANK EXECUTED UNDER THE GUIDANCE OF ARCHITECT & E.S.E

NAME OF OWNER

ANIRUDH MODI (DIRECTOR)
DIRECTOR OF NORTECH PROPERTY PVT. LTD. CONSTITUTED
ATTORNEY FOR BAGIRATHI ABASAN PVT. LTD. & 23 OTHERS
ADDRESS:
6C, ELGIN ROAD, ORIENTAL HOUSE,
KOLKATA - 700073.

CERTIFICATE OF STRUCTURAL ENGINEER

CERTIFIED THAT, "THE STRUCTURAL DESIGN & DRAWINGS OF BOTH FOUNDATION & SUPER STRUCTURE OF THE BUILDING HAS BEEN MADE BY ME CONSIDERING ALL POSSIBLE LOADS INCLUDING THE SEISMIC LOAD AS PER THE NATIONAL BUILDING CODE OF INDIA & CERTIFIED THAT IT IS SAFE & STABLE IN ALL RESPECTS".

NAME OF STRUCTURAL ENGINEER

SANJIV J. PAREKH,
E.S.E. I (104),
SANCTION NO-2022160540 DATED 09.03.2023
VALID UP TO- 08.03.2028

MBC MEETING NO-607 DATED-08.12.2022
MBC RESOLUTION NO-271/22-23

DIGITAL SIGN OF E.E(C)

DIGITAL SIGN OF A.E(C)

NOTE

THE G.L. LEVEL HAS BEEN RAISED BY 450 mm AS DIRECTED BY THE S&D DEPARTMENT FOR THE SMOOTH FLOW OF THE DRAINAGE.

UNDERSIGNED HAS INSPECTED THE SITE AND CARRIED OUT SOIL INVESTIGATION THEREON. IT IS CERTIFIED THAT THE EXISTING SOIL OF THE SITE IS ABLE TO CARRY THE LOAD COMING FROM THE PROPOSED CONSTRUCTION AND THE FOUNDATION SYSTEM PROPOSED HEREIN IS SAFE & STABLE IN ALL RESPECT FROM GEO-TECHNICAL POINT OF VIEW.

NAME OF GEOTECH ENGINEER

JISHNU PAL
LBS LIC NO. :- G.T./1/32
ADDRESS:
NORTH BAKSARA PALPARA, HOWRAH,
P.O.- BAKSARA, P.S.- JAGACHA,
PIN - 711110

RESIDENTIAL:-							
MARKED	TENEMENT SIZE	PROPORTIONAL AREA TO BE ADDED	ACTUAL TENEMENT AREA	NO. OF TENEMENT	NO. OF TENEMENT	TENEMENT CALCULATION	
B1.	116.395	5.969	122.364	01			
B2.	114.655	5.880	120.535	01			
B3.	114.655	5.880	120.535	01			
B4.	114.655	5.880	120.535	01			
B5.	114.655	5.880	120.535	01			
B6.	116.395	5.969	122.364	01			

TOTAL NO. OF FLAT	06	NOS.
TOTAL NOS. OF CAR FOR RESIDENTIAL	06	NOS.
4. PROVIDED CAR PARKING :- (GR. OPEN (SINGLE))	06	NOS.
5. TOTAL STAIR HEAD ROOM AREA :-	84.60	SQM.
6. OVER HEAD TANK AREA :-		NIL
7. TERRACE AREA :-	376.575	SQM.
8. ROOF TOILET AREA :-		NIL
9. OTHER AREA ONLY FOR FEES = (EXEMPTED AREA+SL. NO. - 8)	70.995	SQM.

NAME OF ARCHITECT

RAJ KUMAR AGARWAL
COUNCIL REGISTRATION NO. CA/94/17940
ADDRESS:
RAJ AGRAWAL & ASSOCIATES
8B, ROYD STREET (2ND FLOOR),
KOLKATA-700016.

TITLE BLOCK-B

PLANS, SECTIONS & ELEVATIONS OF RESIDENTIAL BUNGLOW.

PROJECT

PROPOSED G+II STORIED (6.7 M.) RESIDENTIAL & G+II STORIED (12.45 M.) AMENITIES BUILDING AT 9/12/5, YENI SARANI, MOUZA-KALUA, UNDER R.S. DAG NO.-830(P)& 830/1303, R.S. KHATAN NO.-907 & 894, TOUJI NO.- 98, & 58, R.S. NO - 336, J.L. NO - 22, CORRESPONDING TO L.R. DAG NO. - 840 & 867, L.R. KHATAN NO.-7075,7076,7077,7078,7079,7080,7081, 7082,7083,7084,7085,7086,7087,7088,7089,7090,7091,7092, 7093,7094,7095, 7096,7097,7098, BOROUGH -XVI, P.S. - HARIDDEVPUR, DIST - 24 PARGANAS(SOUTH) WITHIN THE K.M.C. PRE. NO. - 9/12/5, YENI SARANI, WARD NO.- 143, KOLKATA - 700104.

DATE	JOB. NO.	DEALT	CHECKED	SHEET NO.
20.10.2022	ARCH/2021/709	GARGI	RAJ SIR	3 OF 7

SCALE-1:100

ARCHITECT

RAJ AGRAWAL & ASSOCIATES
8B, ROYD STREET, KOLKATA - 16